

FIXED POWER WIREWOUND RESISTORS ALUMINIUM HOUSED WITH SCREW LEADS (TOP)

RB/8 Series

These resistors meet or exceed the requirements of MIL - PRF - 18546 G specifications

ELECTRICAL SPECIFICATIONS

- Ohmic values E24 Series. For out of range or not standard ohmic values, consult ATE Technical Dept.
 - Tolerance Standard 5%. Available on request up to 1%
 - Temperature coefficient From ± 100 to ± 30 ppm from R10 to Rmax
 - Dielectric strength 2500Vac / 3500Vac peak
 - Insulation resistance 10000 MOhm minimum 1000 MOhm after moisture test
 - Overload 5s at 5 times rated power
 - Non inductive Models of equivalent physical and electrical specifications are also available with non inductive Ayrton-Perry winding
 - Leads M4 threaded hole
 - Terminal screw tightening torque 1,5Nm (static)
- More technical data as RB50 standard

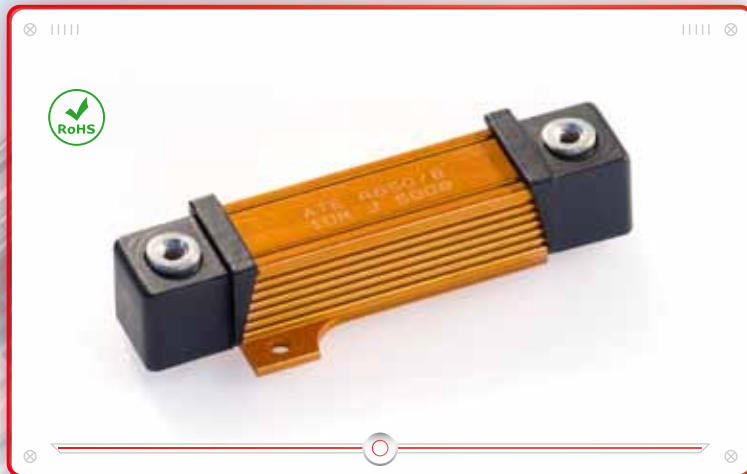

ATE Type	MIL-PRF 18546 G Type	Rated power (W)	Resistance range (Ohm)	Voltage limit (V)	Weight (g)	Heatsink dimensions (cm ² x mm)
RB50/8	RE75	50	0.1 - 68K	1250	52	930 x 1.5

ATE Type	Dimensions (mm)															
	A	B	C	D	F	G	H	J	K	L	M	N	P	Q	R	S
RB50/8	21.5	16	29.2	16	2	39.7	50	79.5	3.2	14.5	M4	8	65	17.5	18.5	16.5
Tol.	± 0.2	± 0.2	± 0.2	± 0.2	± 0.2	± 0.2	± 0.5	± 2	± 0.2	± 0.5	-	-	± 1	± 0.5	± 0.5	± 0.5

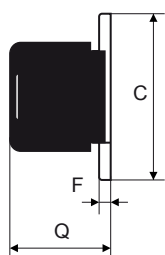

Connection screws supplied with the resistor

